

PRODUCT DESCRIPTION MANUAL

General Motors Corporation
CHEVROLET MOTOR DIVISION

ITEM REFERENCE PROCESS MATERIAL TORQUE EXISTING AS PART OF

14008452	1	FRAME ASM
470799	2	BRACE-FRT FRM L.H. exc LUB
470800	3	BRACE-FRT FRM R.H. exc LUB
473078	4	BOLT /SCREW
1361640	5	NUT
10005519	6	BRACE-FRT FRM &LUB

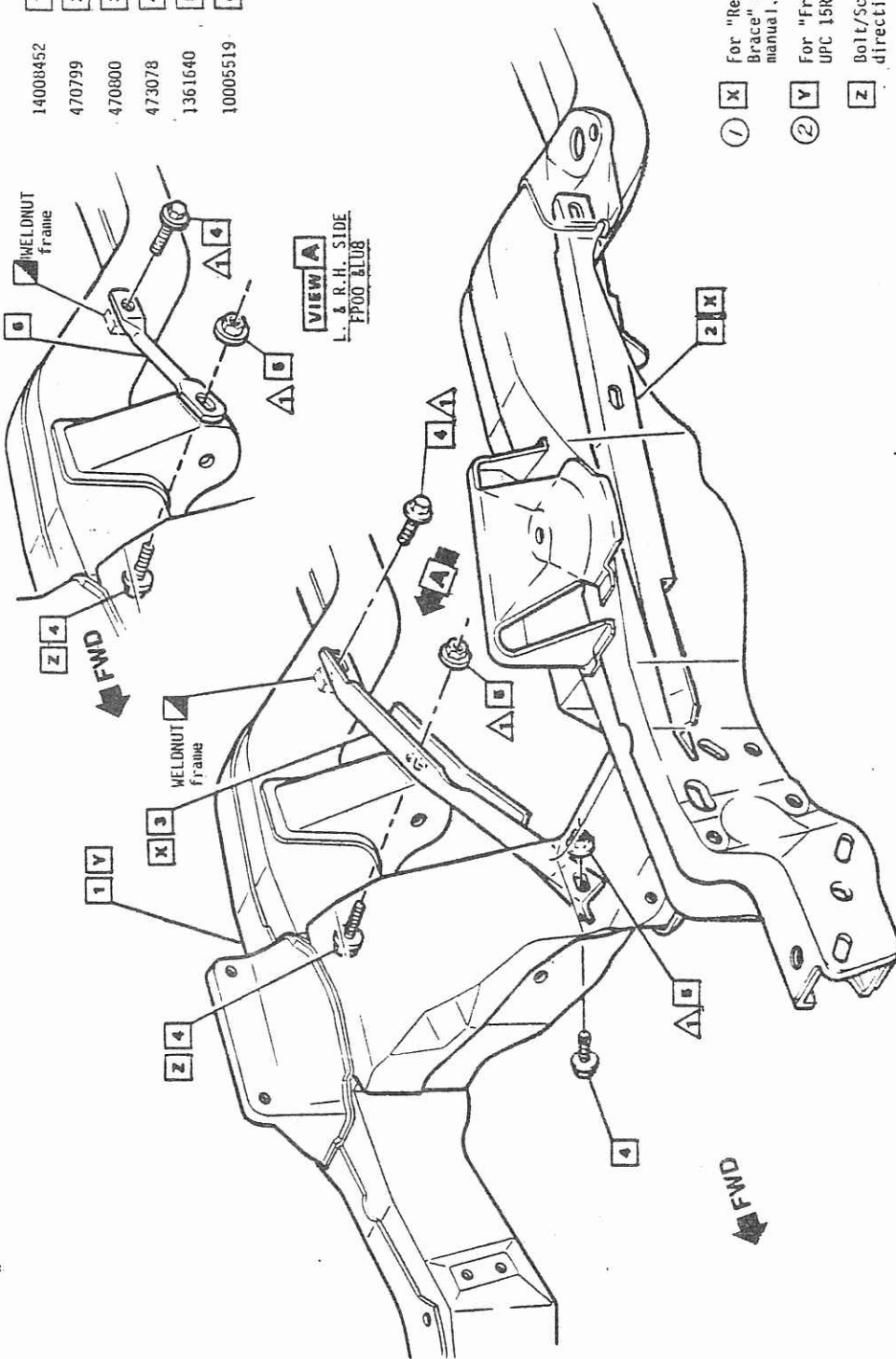

- ① X For "Repair Procedure-Front Crossmember Brace" see UPC 15R REPAIRS in this manual.
- ② Y For "Frame Repair Procedure", see UPC 15R REPAIRS in this manual.
- Z Bolt/Screw must be installed in direction shown.

DATE		22 MAY 80	REVISED	1	NOTE "X" REVISED	SM	22 MAY 80	1	DATE	10 AUG 80	DIV	1981 CHEV. "F" 14020867
AUTH		86419 SM	REVISED	2	NOTE "Y" REVISED (OR 1003)	SM	88765 SM	2	DATE	DR MORRISON/EJM	CHEVROLET	TITLE
APPR									APPR	TE CHUN/HAY/N	CHEVROLET	FRAME ASM & FRT BRACES TO FRT CROSSMEMBER FA00 ALL
APPR									APPR		CHEVROLET	17912-S
APPR									APPR		CHEVROLET	1 BRACES
APPR									APPR		CHEVROLET	1 4920-S
APPR									APPR		CHEVROLET	1 FRAME
APPR									APPR		CHEVROLET	1

FULLY DRIVEN, SEALED & NOT STRIPPED

3 0 P G

